

SETTING SHIMS BOXES VRS 6.2

IDENTIFICATION NUMBERS
CHARACTERISTICS
FITTING POSITION



SUMMARY

CR BOSCH REFERENCE – pg. 02

CR BOSCH INJECTORS - pg. 07

CRIP 1.0-1.2
CRIP 2.2
CRIP 2.1
CRIN 1.0
CRIN 2.0
PIEZO

VOLKSWAGEN I°SERIE
VOLKSWAGEN 16V II°SERIE

CR DELPHI INJECTORS – pg. 15

COMMON RAIL
FH HV
FH BEBE 4 PIN
DAF XF105

CR DENSO INJECTORS pg. 19

X2 TYPE
G2 TOP BL PASSENGER CAR TYPE
G2 TOP BL L-H/D TYPE
G2 SIDE BL PASSENGER CAR TYPE
G2 SIDE BL L-H/D TYPE

CR SIEMENS – PIEZO INJECTORS pg. 24

5 WS 40000 TYPE
5WS 40148 – 40149 TYPE

DX75470 KIT TO GRIND SETTING SHIMS pg. 26

DX75391 DIGITAL MICROMETER GAUGE pg. 27

REFERENCE

BOSCH CRIP 1.0 – 1.2

BOX:DX08050

DX08051

DX08052

DX08054

DX08056

GENUINE REF.

0 445 110 001	0 445 110 064	0 445 110 130
0 445 110 002	0 445 110 065	0 445 110 141
0 445 110 003	0 445 110 066	0 445 110 144
0 445 110 004	0 445 110 068	0 445 110 145
0 445 110 005	0 445 110 069	0 445 110 146
0 445 110 006	0 445 110 070	0 445 110 151
0 445 110 008	0 445 110 071	0 445 110 152
0 445 110 009	0 445 110 072	0 445 110 160
0 445 110 010	0 445 110 073	0 445 110 170
0 445 110 011	0 445 110 074	0 445 110 171
0 445 110 012	0 445 110 076	0 445 110 173
0 445 110 014	0 445 110 081	0 445 110 178
0 445 110 015	0 445 110 084	0 445 110 181
0 445 110 017	0 445 110 086	0 445 110 182
0 445 110 018	0 445 110 087	0 445 110 184
0 445 110 019	0 445 110 088	0 445 110 185
0 445 110 020	0 445 110 089	0 445 110 186
0 445 110 021	0 445 110 090	0 445 110 189
0 445 110 022	0 445 110 091	0 445 110 190
0 445 110 023	0 445 110 092	0 445 110 195
0 445 110 024	0 445 110 093	0 445 110 196
0 445 110 025	0 445 110 094	0 445 110 197
0 445 110 028	0 445 110 095	0 445 110 198
0 445 110 029	0 445 110 096	0 445 110 199
0 445 110 030	0 445 110 097	0 445 110 200
0 445 110 031	0 445 110 098	0 445 110 201
0 445 110 034	0 445 110 099	0 445 110 202
0 445 110 035	0 445 110 100	0 445 110 203
0 445 110 036	0 445 110 101	0 445 110 204
0 445 110 038	0 445 110 102	0 445 110 205
0 445 110 042	0 445 110 103	0 445 110 206
0 445 110 043	0 445 110 104	0 445 110 207
0 445 110 044	0 445 110 105	0 445 110 208
0 445 110 045	0 445 110 106	0 445 110 221
0 445 110 046	0 445 110 107	0 445 110 222
0 445 110 047	0 445 110 108	0 445 110 223
0 445 110 048	0 445 110 109	0 445 110 224
0 445 110 049	0 445 110 110	0 445 110 225
0 445 110 052	0 445 110 113	0 445 110 231
0 445 110 053	0 445 110 114	0 445 110 240
0 445 110 056	0 445 110 115	0 445 110 279
0 445 110 057	0 445 110 116	0 445 110 283
0 445 110 058	0 445 110 119	0 445 110 290
0 445 110 059	0 445 110 120	0 445 110 306
0 445 110 060	0 445 110 121	0 445 110 336
0 445 110 061	0 445 110 125	0 445 110 337
0 445 110 062	0 445 110 126	
0 445 110 063	0 445 110 127	

REFERENCE

BOSCH CRIP 2.2

BOX:DX08051 DX08086

DX08052

DX08056

DX08054

DX08080

GENUINE REF.

0 445 110 083	0 445 110 301	0 445 110 362
0 445 110 111	0 445 110 302	0 445 110 363
0 445 110 112	0 445 110 303	0 445 110 364
0 445 110 159	0 445 110 304	0 445 110 365
0 445 110 165	0 445 110 305	0 445 110 366
0 445 110 183	0 445 110 308	0 445 110 367
0 445 110 187	0 445 110 309	0 445 110 370
0 445 110 209	0 445 110 310	0 445 110 372
0 445 110 212	0 445 110 311	0 445 110 373
0 445 110 213	0 445 110 312	0 445 110 374
0 445 110 216	0 445 110 313	0 445 110 375
0 445 110 219	0 445 110 316	0 445 110 376
0 445 110 237	0 445 110 317	0 445 110 377
0 445 110 238	0 445 110 318	0 445 110 378
0 445 110 243	0 445 110 319	0 445 110 379
0 445 110 244	0 445 110 320	0 445 110 380
0 445 110 247	0 445 110 321	0 445 110 383
0 445 110 248	0 445 110 322	0 445 110 384
0 445 110 252	0 445 110 325	0 445 110 385
0 445 110 253	0 445 110 326	0 445 110 386
0 445 110 254	0 445 110 327	0 445 110 387
0 445 110 255	0 445 110 328	0 445 110 388
0 445 110 256	0 445 110 329	0 445 110 389
0 445 110 257	0 445 110 330	0 445 110 390
0 445 110 258	0 445 110 331	0 445 110 391
0 445 110 260	0 445 110 332	0 445 110 392
0 445 110 261	0 445 110 333	0 445 110 393
0 445 110 265	0 445 110 334	0 445 110 394
0 445 110 267	0 445 110 335	0 445 110 395
0 445 110 268	0 445 110 338	0 445 110 396
0 445 110 269	0 445 110 339	0 445 110 397
0 445 110 270	0 445 110 340	0 445 110 400
0 445 110 273	0 445 110 343	0 445 110 401
0 445 110 274	0 445 110 344	0 445 110 402
0 445 110 275	0 445 110 345	0 445 110 403
0 445 110 276	0 445 110 346	0 445 110 404
0 445 110 277	0 445 110 347	0 445 110 407
0 445 110 278	0 445 110 348	
0 445 110 280	0 445 110 352	
0 445 110 281	0 445 110 353	
0 445 110 287	0 445 110 354	
0 445 110 289	0 445 110 355	
0 445 110 291	0 445 110 356	
0 445 110 293	0 445 110 357	
0 445 110 297	0 445 110 358	
0 445 110 298	0 445 110 359	
0 445 110 299	0 445 110 360	
0 445 110 300	0 445 110 361	

REFERENCE

BOSCH CRIP 2.1

BOX:DX08051 DX08081

DX08053

DX08054

DX08056

DX08068

GENUINE REF.

0 445 110 054	0 445 110 218
0 445 110 055	0 445 110 227
0 445 110 075	0 445 110 229
0 445 110 077	0 445 110 230
0 445 110 078	0 445 110 232
0 445 110 082	0 445 110 233
0 445 110 085	0 445 110 236
0 445 110 118	0 445 110 239
0 445 110 122	0 445 110 249
0 445 110 128	0 445 110 250
0 445 110 129	0 445 110 251
0 445 110 131	0 445 110 259
0 445 110 134	0 445 110 262
0 445 110 135	0 445 110 263
0 445 110 136	0 445 110 264
0 445 110 137	0 445 110 271
0 445 110 138	0 445 110 282
0 445 110 139	0 445 110 284
0 445 110 140	0 445 110 285
0 445 110 142	0 445 110 286
0 445 110 143	0 445 110 288
0 445 110 149	0 445 110 294
0 445 110 150	0 445 110 295
0 445 110 153	0 445 110 296
0 445 110 154	0 445 110 307
0 445 110 155	0 445 110 315
0 445 110 156	0 445 110 323
0 445 110 157	0 445 110 324
0 445 110 158	0 445 110 349
0 445 110 162	0 445 110 350
0 445 110 163	0 445 110 371
0 445 110 166	0 445 110 381
0 445 110 167	
0 445 110 168	
0 445 110 169	
0 445 110 172	
0 445 110 174	
0 445 110 175	
0 445 110 176	
0 445 110 177	
0 445 110 188	
0 445 110 191	
0 445 110 192	
0 445 110 193	
0 445 110 194	
0 445 110 214	
0 445 110 215	
0 445 110 217	



REFERENCE

BOSCH CRIN 1.0

BOX:DX08051

DX08057

DX08071

DX08083

DX08084

GENUINE REF.

0 445 120 002	0 445 120 125
0 445 120 003	0 445 120 132
0 445 120 004	0 445 120 133
0 445 120 006	0 445 120 140
0 445 120 007	0 445 120 144
0 445 120 008	0 445 120 151
0 445 120 009	0 445 120 152
0 445 120 010	0 445 120 159
0 445 120 020	0 445 120 173
0 445 120 025	0 445 120 174
0 445 120 028	0 445 120 175
0 445 120 029	0 445 120 176
0 445 120 031	0 445 120 208
0 445 120 032	0 445 120 209
0 445 120 033	0 445 120 210
0 445 120 034	0 445 120 211
0 445 120 035	0 445 120 212
0 445 120 036	0 445 120 231
0 445 120 037	0 445 120 236
0 445 120 038	0 445 120 237
0 445 120 040	0 445 120 238
0 445 120 041	0 445 120 240
0 445 120 043	0 445 120 241
0 445 120 044	
0 445 120 046	
0 445 120 051	
0 445 120 052	
0 445 120 059	
0 445 120 060	
0 445 120 069	
0 445 120 070	
0 445 120 077	
0 445 120 079	
0 445 120 084	
0 445 120 085	
0 445 120 089	
0 445 120 094	
0 445 120 097	
0 445 120 103	
0 445 120 108	
0 445 120 112	
0 445 120 113	
0 445 120 114	
0 445 120 115	
0 445 120 119	
0 445 120 120	
0 445 120 121	
0 445 120 122	
0 445 120 123	

REFERENCE

BOSCH CRIN 2.0

BOX:DX08051

DX08054

DX08067

DX08068

DX08087

GENUINE REF.

0 445 120 024	0 445 120 135	0 445 120 200
0 445 120 026	0 445 120 136	0 445 120 201
0 445 120 030	0 445 120 137	0 445 120 202
0 445 120 044	0 445 120 138	0 445 120 203
0 445 120 045	0 445 120 139	0 445 120 204
0 445 120 050	0 445 120 141	0 445 120 213
0 445 120 053	0 445 120 142	0 445 120 214
0 445 120 054	0 445 120 143	0 445 120 215
0 445 120 055	0 445 120 145	0 445 120 217
0 445 120 056	0 445 120 146	0 445 120 218
0 445 120 057	0 445 120 147	0 445 120 219
0 445 120 061	0 445 120 148	0 445 120 220
0 445 120 062	0 445 120 149	0 445 120 227
0 445 120 063	0 445 120 150	0 445 120 228
0 445 120 064	0 445 120 153	0 445 120 229
0 445 120 065	0 445 120 154	0 445 120 232
0 445 120 066	0 445 120 155	0 445 120 233
0 445 120 067	0 445 120 156	0 445 120 235
0 445 120 068	0 445 120 157	0 445 120 245
0 445 120 071	0 445 120 158	
0 445 120 074	0 445 120 160	
0 445 120 075	0 445 120 161	
0 445 120 078	0 445 120 162	
0 445 120 080	0 445 120 163	
0 445 120 081	0 445 120 164	
0 445 120 083	0 445 120 165	
0 445 120 086	0 445 120 166	
0 445 120 087	0 445 120 167	
0 445 120 088	0 445 120 168	
0 445 120 092	0 445 120 169	
0 445 120 098	0 445 120 170	
0 445 120 099	0 445 120 177	
0 445 120 101	0 445 120 178	
0 445 120 102	0 445 120 179	
0 445 120 105	0 445 120 180	
0 445 120 106	0 445 120 181	
0 445 120 107	0 445 120 182	
0 445 120 110	0 445 120 183	
0 445 120 111	0 445 120 184	
0 445 120 116	0 445 120 185	
0 445 120 117	0 445 120 186	
0 445 120 118	0 445 120 187	
0 445 120 124	0 445 120 188	
0 445 120 127	0 445 120 191	
0 445 120 128	0 445 120 192	
0 445 120 129	0 445 120 193	
0 445 120 130	0 445 120 196	
0 445 120 131	0 445 120 197	
0 445 120 134	0 445 120 199	

CR BOSCH INJECTORS

BOSCH Common Rail Injector CRIP 1.0 - 1.2

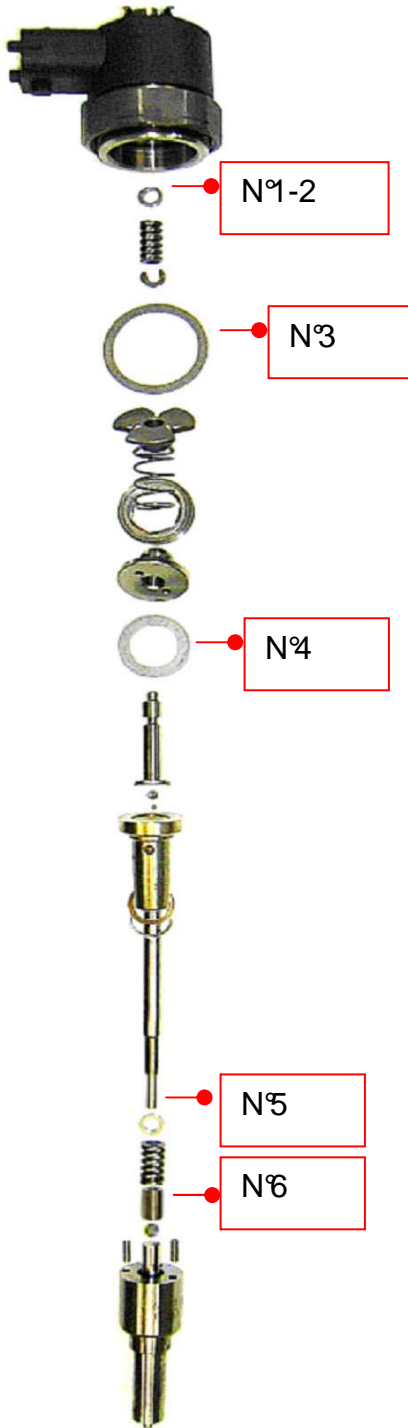

N°1 DX08050	Solenoid Spring Shim Box
24 Position Box	From DX 923124 to DX 923168 Bag
$\frac{1}{2}$	From 1,24 to 1,68 mm (step 0,02)
\bigcirc	\varnothing int. 02,50 - \varnothing ext. 05,30

N°2 DX08051	Nozzle Spring Shim Box
24 Position Box	From DX 921105 to DX 921230 Bag
$\frac{1}{2}$	From 1,05 to 2,30 mm (step 0,05)
\bigcirc	\varnothing int. 03,50 - \varnothing ext. 05,30

N°3 DX08056	Solenoid Spring Shim Box
12 Position Box	From DX 922102 to DX 922113 Bag
$\frac{1}{2}$	From 1,02 to 1,13 mm (step 0,01)
\bigcirc	\varnothing int. 19,00 - \varnothing ext. 23,70

N°4 DX08052	Valve Lift Shim Box
12 Position Box	From DX 925120 to DX 925131 Bag
$\frac{1}{2}$	From 1,20 to 1,31 mm (step 0,01)
\bigcirc	\varnothing int. 10,50 - \varnothing ext. 15,70

N°5 DX08051	Nozzle Spring Shim Box
24 Position Box	From DX 921105 to DX 921230 Bag
$\frac{1}{2}$	From 1,05 to 2,30 mm (step 0,05)
\bigcirc	\varnothing int. 03,50 - \varnothing ext. 05,30

N°6 DX08054	DGV Nozzle Needle LiftBox
12 Position Box	From DX 926104 to DX 926126 Bag
$\frac{1}{2}$	From 1,04 to 1,26 mm (step 0,02)

CR BOSCH INJECTORS

BOSCH Common Rail Injector CRIP 2.2

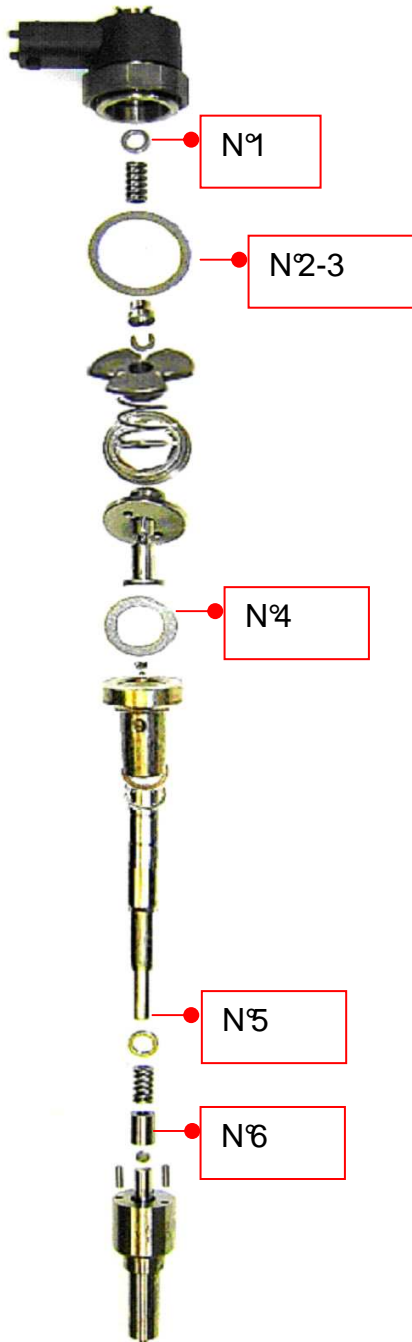

N°1 DX08086	Solenoid Spring Shim Box
24 Position Box	From DX 950115 to DX 950230 Bag
$\frac{1}{2}$	From 1,15 to 2,30 mm (step 0,05)
\bigcirc	\varnothing int. 02,80 - \varnothing ext. 05,00

N°2 DX08056	Solenoid Shim Box
12 Position Box	From DX 922102 to DX 922113 Bag
$\frac{1}{2}$	From 1,02 to 1,13 mm (step 0,01)
\bigcirc	\varnothing int. 19,00 - \varnothing ext. 23,70

N°3 DX08080	Solenoid Shim Box
12 Position Box	From DX 922114 to DX 922125 Bag
$\frac{1}{2}$	From 1,14 to 1,25 mm (step 0,01)
\bigcirc	\varnothing int. 19,00 - \varnothing ext. 23,70

N°4 DX08052	Valve Lift Shim Box
12 Position Box	From DX 925120 to DX 925131 Bag
$\frac{1}{2}$	From 1,20 to 1,31 mm (step 0,01)
\bigcirc	\varnothing int. 10,50 - \varnothing ext. 15,70

N°5 DX08051	Nozzle Spring Shim Box
24 Position Box	From DX 921105 to DX 921230 Bag
$\frac{1}{2}$	From 1,05 to 2,30 mm (step 0,05)
\bigcirc	\varnothing int. 03,50 - \varnothing ext. 05,30

N°6 DX08054	DGV Nozzle Needle LiftBox
12 Position Box	From DX 926104 to DX 926126 Bag
$\frac{1}{2}$	From 1,04 to 1,26 mm (step 0,02)

CR BOSCH INJECTORS

BOSCH Common Rail Injector CRIP 2.1



N°1 DX08053	Solenoid Shim Box
12 Position Box	From DX 920145 to DX 920200 Bag
$\frac{\downarrow}{\uparrow}$	From 1,45 to 2,00 mm (step 0,05)
\bigcirc	\varnothing int. 02,50 - \varnothing ext. 04,50

N°2 DX08081	Solenoid Spring Shim Box
12 Position Box	From DX 922090 to DX 922101 Bag
$\frac{\downarrow}{\uparrow}$	From 0,90 to 1,01 mm (step 0,01)
\bigcirc	\varnothing int. 19,00 - \varnothing ext. 23,70

N°3 DX08056	Solenoid Spring Shim Box
12 Position Box	From DX 922102 to DX 922113 Bag
$\frac{\downarrow}{\uparrow}$	From 1,02 to 1,13 mm (step 0,01)
\bigcirc	\varnothing int. 19,00 - \varnothing ext. 23,70

N°4 DX08051	Nozzle Spring Shim Box
24 Position Box	From DX 921105 to DX 921230 Bag
$\frac{\downarrow}{\uparrow}$	From 1,05 to 2,30 mm (step 0,05)
\bigcirc	\varnothing int. 03,50 - \varnothing ext. 05,30

N°5 DX08054	DGV Nozzle Needle LiftBox
12 Position Box	From DX 926104 to DX 926126 Bag
$\frac{\downarrow}{\uparrow}$	From 1,04 to 1,26 mm (step 0,02)

N°6 DX08068	DGV Nozzle Needle LiftBox
12 Position Box	From DX 926128 to DX 926150 Bag
$\frac{\downarrow}{\uparrow}$	From 1,28 to 1,50 mm (step 0,02)

CR BOSCH INJECTORS

BOSCH Common Rail Injector CRIN 1.0

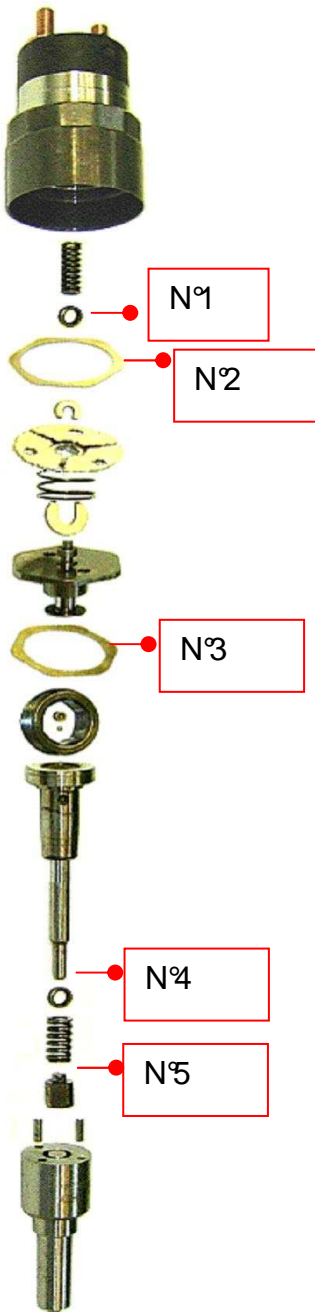

N°1 DX08057	Solenoid Spring Shim Box
24 Position Box	From DX 948115 to DX 948230 Bag
	From 1,15 to 2,30 mm (step 0,05)
	Ø int. 02,30 - Ø ext. 04,00

N°2 DX08084	Solenoid Shim Box
12 Position Box	From DX 924120 to DX 924142 Bag
	From 1,20 to 1,42 mm (step 0,02)
	Ø int. 19,00 - Ø ext. 23,70

N°3 DX08083	Valve Lift Shim Box
24 Position Box	From DX 924095 to DX 924118 Bag
	From 0,95 to 1,18 mm (step 0,01)
	Ø int. 19,00 - Ø ext. 23,70

N°4 DX08051	Nozzle Spring Shim Box
24 Position Box	From DX 921105 to DX 921230 Bag
	From 1,05 to 2,30 mm (step 0,05)
	Ø int. 03,50 - Ø ext. 05,30

N°5 DX08071	Calibrate Flare Spacer Box
12 Position Box	From DX 928828 to DX 928850 Bag
	From 8,28 to 8,50 mm (step 0,02)

CR BOSCH INJECTORS

BOSCH Common Rail Injector CRIN 2.0



N°1 DX08087	Solenoid Spring Shim Box
24 Position Box	From DX 951115 to DX 951230 Bag
$\frac{1}{4}$	From 1,15 to 2,30 mm (step 0,05)
\bigcirc	Ø int. 02,30 - Ø ext. 04,20

N°2 DX08067	Man Solenoid Shim Box
24 Position Box	From DX 942150 to DX 942173 Bag
$\frac{1}{4}$	From 1,50 to 1,73 mm (step 0,01)
\bigcirc	Ø int. 19,60 - Ø ext. 22,80

N°3 DX08051	Nozzle Spring Shim Box
24 Position Box	From DX 921105 to DX 921230 Bag
$\frac{1}{4}$	From 1,05 to 2,30 mm (step 0,05)
\bigcirc	Ø int. 03,50 - Ø ext. 05,30

N°4 DX08054	DGV Nozzle Needle LiftBox
12 Position Box	From DX 926104 to DX 926126 Bag
$\frac{1}{4}$	From 1,04 to 1,26 mm (step 0,02)

N°5 DX08068	DGV Nozzle Needle LiftBox
12 Position Box	From DX 926128 to DX 926150 Bag
$\frac{1}{4}$	From 1,28 to 1,50 mm (step 0,02)

CR BOSCH INJECTORS

BOSCH PIEZO





N°1

N°1 DX08090	Nozzle Spring Shim Box
12 Position Box	From DX 946120 to DX 946230 Bag
$\frac{\downarrow}{\uparrow}$	From 1,20 to 2,30 mm (step 0,10)
\bigcirc	\varnothing int. 03,55 - \varnothing ext. 05,35

CR BOSCH INJECTORS

BOSCH VOLKSWAGEN I°SERIE

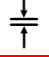

N°1 DX08076	Solenoid Spring Shim Box
24 Position Box	From DX 933120 to DX 933235 Bag
	From 1,20 to 2,35 mm (step 0,05)
	Ø ext. 09,20

CR BOSCH INJECTORS

BOSCH VOLKSWAGEN II° SERIE

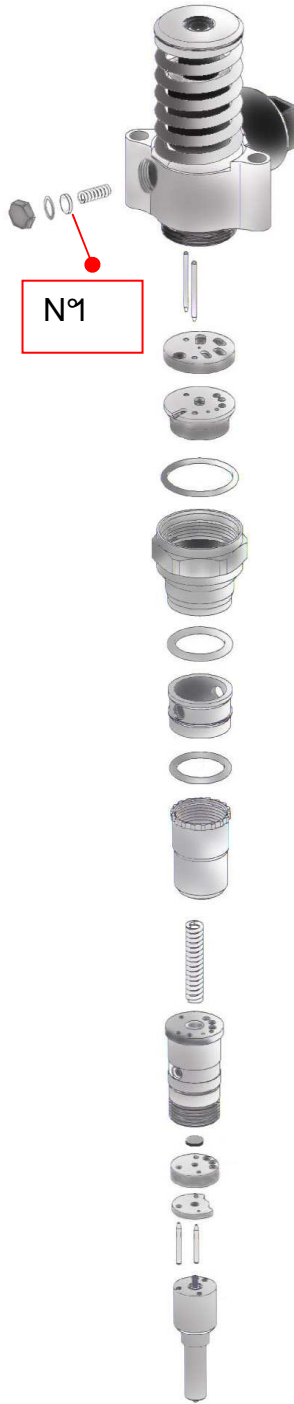

N°1 DX08077	Solenoid Spring Shim Box
24 Position Box	From DX 934120 to DX 934235 Bag
	From 1,20 to 2,35 mm (step 0,05)
	Ø ext. 04,60

DELPHI INJECTORS

DELPHI COMMON RAIL

N°1 DX08061	Spring Pin Shim Box
12 Position Box	From DX 929380 to DX 929490 Bag
$\frac{\downarrow}{\uparrow}$	From 3,80 to 4,90 mm (step 0,10)

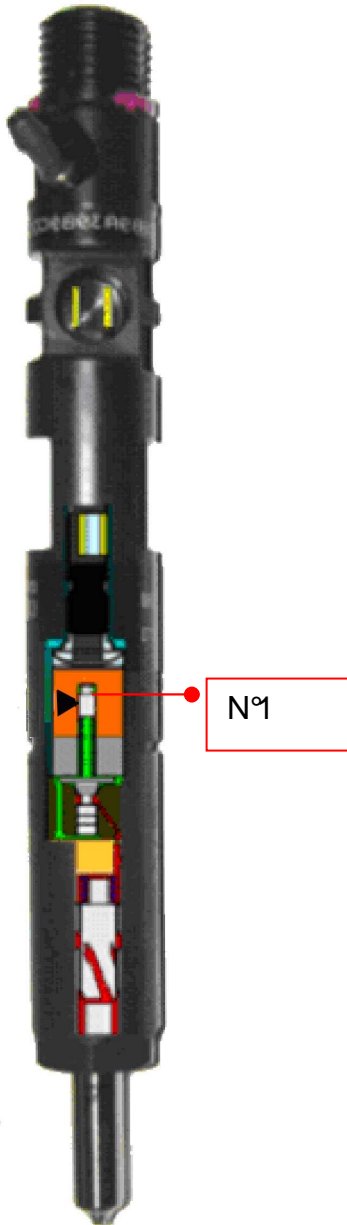

DELPHI INJECTORS

Volvo Injector FH HV DELPHI TYPE



N1

N°1 DX08073	Solenoid Shim Box
12 Position Box	From DX 931050 to DX 931105 Bag
$\frac{\downarrow}{\uparrow}$	From 0,50 to 1,05 mm (step 0,05)
\bigcirc	Ø int. 02,50 - Ø ext. 04,90

N°2 DX08074	Nozzle Spring Shim Box
12 Position Box	From DX 932050 to DX 932105 Bag
$\frac{\downarrow}{\uparrow}$	From 0,50 to 1,05 mm (step 0,05)
\bigcirc	Ø int. 02,50 - Ø ext. 07,40



N2

DELPHI INJECTORS

Volvo Injector FH BEBE 4 PIN



N°1 DX08092	Nozzle Opening Pressure Shim Box
21 Position Box	From DX 937040 to DX 937080 Bag
$\frac{\downarrow}{\uparrow}$	From 0,40 to 0,80 mm (step 0,02)
\bigcirc	\varnothing int. 04,70 - \varnothing ext. 09,35

N°2 DX08094	Solenoid Shim Box
12 Position Box	From DX 939110 to DX 939170 Bag
$\frac{\downarrow}{\uparrow}$	From 1,10 to 1,70 mm (step 0,05)
\bigcirc	\varnothing int. 01,77 - \varnothing ext. 04,35

DELPHI INJECTORS

Smart Injector DAF XF105



N°1 DX08073	Solenoid Shim Box
12 Position Box	From DX 931050 to DX 931105 Bag
$\frac{1}{12}$	From 0,50 to 1,05 mm (step 0,05)
\bigcirc	Ø int. 02,50 - Ø ext. 04,90

N°2 DX08093	Nozzle Opening Pressure Shim Box
21 Position Box	From DX 938040 to DX 938080 Bag
$\frac{1}{21}$	From 0,40 to 0,80 mm (step 0,02)
\bigcirc	Ø int. 04,80 - Ø ext. 08,35

N°3 DX08094	Solenoid Shim Box
12 Position Box	From DX 939110 to DX 939170 Bag
$\frac{1}{12}$	From 1,10 to 1,70 mm (step 0,05)
\bigcirc	Ø int. 01,77 - Ø ext. 04,35

CR DENSO INJECTORS



DENSO Common Rail X2 TYPE





N°1

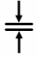

N°2

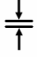
N°1 DX08065	Solenoid Shim Box
12 Position Box	From DX 943299 to DX 943310 Bag
	From 2,99 to 3,10 mm (step 0,01)
	Ø int. 20,00 - Ø ext. 23,20

N°2 DX08069	Nozzle Spring Shim Box
12 Position Box	From DX 944175 to DX 944230 Bag
	From 1,75 to 2,30 mm (step 0,05)
	Ø int. 03,55 - Ø ext. 06,75

CR DENSO INJECTORS

DENSO Common Rail G2 TOP BL PASSENGER CAR TYPE



N°1 DX08400	Solenoid Shim Box
24 Position Box	From DX 927150 to DX 927173 Bag
$\frac{\downarrow}{\uparrow}$	From 1,50 to 1,73 mm (step 0,01)
\bigcirc	\varnothing int. 21,50 - \varnothing ext. 24,20

N°2 DX08062	Nozzle Spring Shim Box
12 Position Box	From DX 940125 to DX 940180 Bag
$\frac{\downarrow}{\uparrow}$	From 1,25 to 1,80 mm (step 0,05)
\bigcirc	\varnothing int. 03,00 - \varnothing ext. 05,60



CR DENSO INJECTORS



DENSO Common Rail G2 TOP BL L-H/D TYPE

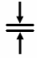

N°1

N2

N°1 DX08400	Solenoid Shim Box
24 Position Box	From DX 927150 to DX 927173 Bag
	From 1,50 to 1,73 mm (step 0,01)
	Ø int. 21,50 - Ø ext. 24,20

N°2 DX08069	Nozzle Spring Shim Box
12 Position Box	From DX 944175 to DX 944230 Bag
	From 1,75 to 2,30 mm (step 0,05)
	Ø int. 03,55 - Ø ext. 06,75

CR DENSO INJECTORS

DENSO Common Rail **G2 SIDE BL PASSENGER CAR TYPE**



N°1	DX08095	Solenoid Shim Box
24 Position Box		From DX 952090 to DX 952205 Bag
$\frac{\downarrow}{\uparrow}$		From 0,90 to 2,05 mm (step 0,05)
		Ø int. 01,80 - Ø ext. 03,95

N°2	DX08400	Solenoid Shim Box
24 Position Box		From DX 927150 to DX 927173 Bag
$\frac{\downarrow}{\uparrow}$		From 1,50 to 1,73 mm (step 0,01)
		Ø int. 21,50 - Ø ext. 24,20

N°3	DX08062	Nozzle Spring Shim Box
12 Position Box		From DX 940125 to DX 940180 Bag
$\frac{\downarrow}{\uparrow}$		From 1,25 to 1,80 mm (step 0,05)
		Ø int. 03,00 - Ø ext. 05,60

CR DENSO INJECTORS

DENSO Common Rail G2 SIDE BL L-H/D TYPE

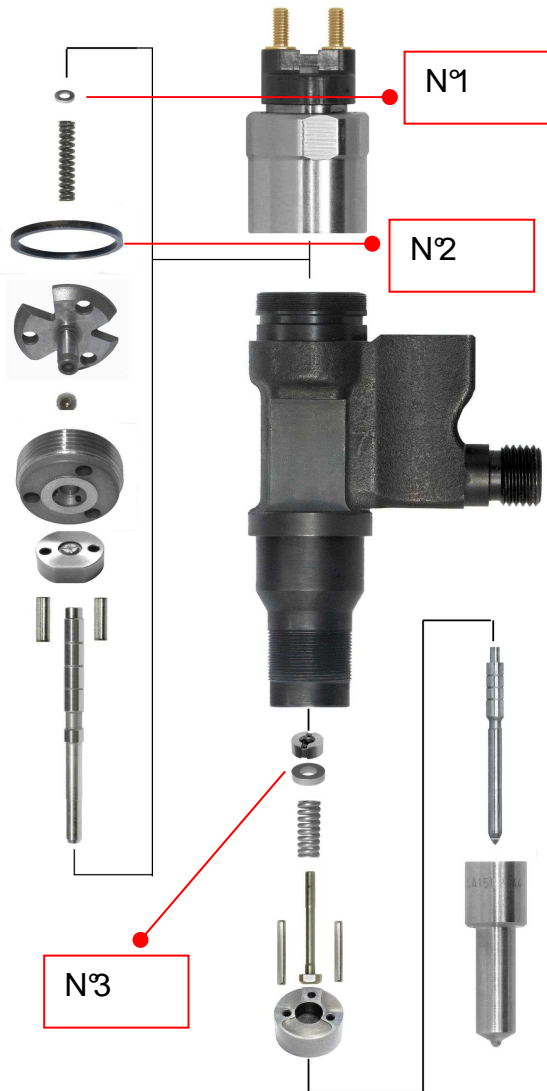

N°1	DX084095	Solenoid Shim Box
24 Position Box		From DX 952090 to DX 952205 Bag
$\frac{\downarrow}{\uparrow}$		From 0,90 to 2,05 mm (step 0,05)
		Ø int. 01,80 - Ø ext. 03,95

N°2	DX08400	Solenoid Shim Box
24 Position Box		From DX 927150 to DX 927173 Bag
$\frac{\downarrow}{\uparrow}$		From 1,50 to 1,73 mm (step 0,01)
		Ø int. 21,50 - Ø ext. 24,20

N°3	DX08069	Nozzle Spring Shim Box
12 Position Box		From DX 944175 to DX 944230 Bag
$\frac{\downarrow}{\uparrow}$		From 1,75 to 2,30 mm (step 0,05)
		Ø int. 03,55 - Ø ext. 06,75

CR SIEMENS-PIEZO INJECTORS

SIEMENS-PIEZO Common Rail Injector 5 WS 40000 TYPE



N°1 DX08064	Piezo Actuator Shim Box
12 Position Box	From DX 941090 to DX 941101 Bag
$\frac{\downarrow}{\uparrow}$	From 0,90 to 1,01 mm (step 0,01)
\bigcirc	\varnothing int. 13,70 - \varnothing ext. 19,90

N°2 DX08401	Piezo Actuator Shim Box
12 Position Box	From DX 941102 to DX 941113 Bag
$\frac{\downarrow}{\uparrow}$	From 1,02 to 1,13 mm (step 0,01)
\bigcirc	\varnothing int. 13,70 - \varnothing ext. 19,90

N°3 DX08062	Nozzle Spring Shim Box
12 Position Box	From DX 940125 to DX 940180 Bag
$\frac{\downarrow}{\uparrow}$	From 1,25 to 1,80 mm (step 0,05)
\bigcirc	\varnothing int. 03,00 - \varnothing ext. 05,60

CR SIEMENS-PIEZO INJECTORS

SIEMENS-PIEZO Common Rail Injector 5 WS 40148 - 40149 TYPE



N°1 DX08088	Piezo Solenoid Shim Box
24 Position Box	From DX 949090 to DX 949113 Bag
	From 0,90 to 1,13 mm (step 0,01)
	Ø int. 14,40 - Ø ext. 19,60

N°2 DX08062	Nozzle Spring Shim Box
12 Position Box	From DX 940125 to DX 940180 Bag
	From 1,25 to 1,80 mm (step 0,05)
	Ø int. 03,00 - Ø ext. 05,60

DX75470

KIT TO GRIND SETTING SHIMS ON CR INJECTORS



EASY TO USE !

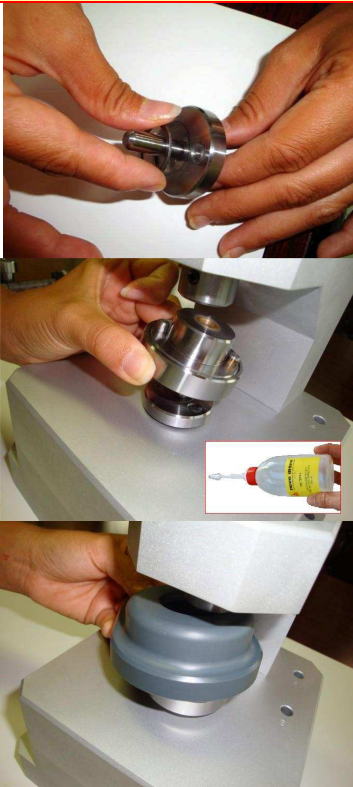

1 - Shim fitting on its Holder

2 - Fitting of grinding disc support on DX75480 grinding machine.

3 - Top holder fitting

GRINDING DISCS

Kit includes:

- Article DX75723 Thin grinding discs (Kit 10 pz.)
- Article DX75724 Medium grinding discs (Kit 10 pz.)
- Article DX75729 Thick grinding discs (Kit 10 pz.)

ATTENTION !

- To use of the DX75470 Kit is necessarily linked to the availability of the Ball seat reconditioning DX75480.
- For the correct use of the DX75470 Kit is recommended synthetic liquid DX75374.
- For the measurement of the thickness is recommended Digital micrometer gauge DX75391.

DX75391 DIGITAL MICROMETER GAUGE



LCD Display
Travel mm 0-25
Resolution mm 0.001
Isolation IP54
Precision DIN 863

DX75392 MICROMETER GAUGE HOLDER



COMPLET KIT (Recommended)

ATTENTION !

- This brochure should be considered a useful guide for the operator.
We decline all responsibility for any mistake or modification occurred after the compilation of this brochure.
- Numbers and codes are listed in the original for reference purposes only
- At exhaustion of individual measures, replacement is available on request (10 pcs. Bag).
- Shims with different thickness, not included in the boxes can be available on request (10 pcs. Bag).

ATTENZIONE !

- Questo prontuario vuole rappresentare una guida utile per l'utente.
Decliniamo qualsiasi responsabilità per eventuali errori o modifiche successivamente intervenute alla compilazione del prontuario stesso.
- Numeri e codici originali sono riportati a puro titolo di riferimento.
- Singole misure di spessori in esaurimento sono disponibili su ordinazione (Bustine da 10 pz.).
- Singole misure di spessori non comprese nelle cassette possono essere disponibili su richiesta (Bustine da 10 pz.).

